

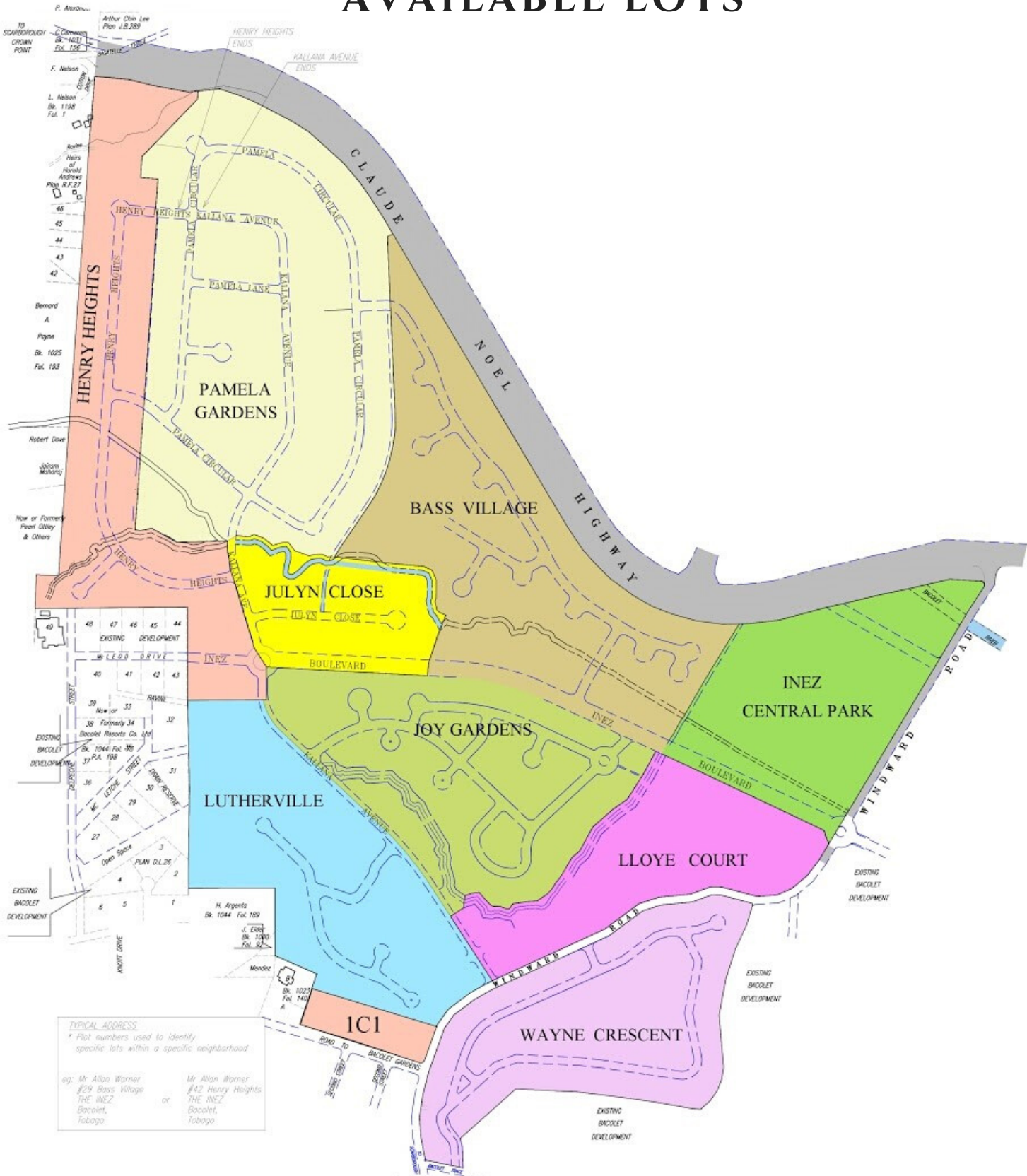

# INEZ

INVESTMENTS

## AVAILABLE LOTS



**TYPICAL ADDRESS**  
\* Plot numbers used to identify specific lots within a specific neighborhood.

eg: Mr Allan Warner #29 Bass Village  
THE INEZ Bacolet, Tobago

or

Mr Allan Warner #42 Henry Heights  
THE INEZ Bacolet, Tobago

# BASS VILLAGE





# BASS VILLAGE - PRICE LIST

| LOT NO. | LOT SIZE(SM) | LOT SIZE (SQFT) | PRICE/SQFT | ORIGINAL PURCHASING PRICE (\$) |
|---------|--------------|-----------------|------------|--------------------------------|
| 46      | 510.6        | 5496            | 75         | \$ 412,204                     |
| 47      | 595.2        | 6407            | 75         | \$ 480,500                     |
| 50      | 500.4        | 5386            | 75         | \$ 403,969                     |
| 51      | 659.6        | 7100            | 75         | \$ 532,490                     |
| 56      | 554.4        | 5968            | 75         | \$ 447,563                     |
| 58      | 487.7        | 5250            | 75         | \$ 393,717                     |
| 59      | 632.4        | 6807            | 75         | \$ 510,532                     |
| 64      | 563          | 6060            | 75         | \$ 454,506                     |
| 67      | 498.9        | 5370            | 75         | \$ 402,758                     |
| 68      | 497.7        | 5357            | 75         | \$ 401,789                     |
| 73      | 474.3        | 5105            | 75         | \$ 382,899                     |
| 84      | 600          | 600             | 75         | \$ 484,376                     |
| 85      | 508.8        | 509             | 75         | \$ 410,750                     |
| 86      | 536.7        | 537             | 75         | \$ 433,274                     |
| 87      | 555.5        | 5979            | 75         | \$ 448,451                     |
| 91      | 542.3        | 5837            | 75         | \$ 437,795                     |
| 92      | 469.6        | 5055            | 75         | \$ 379,105                     |
| 93      | 530          | 5705            | 75         | \$ 427,865                     |
| 94      | 471.2        | 5072            | 75         | \$ 380,396                     |
| 98      | 554.6        | 5970            | 75         | \$ 425,000                     |
| 100     | 464.7        | 5002            | 75.00      | \$ 425,000                     |

# BASS VILLAGE - PRICE LIST

| LOT NO. | LOT SIZE(SM) | LOT SIZE (SQFT) | PRICE/SQFT | ORIGINAL PURCHASING PRICE (\$) |
|---------|--------------|-----------------|------------|--------------------------------|
| 101     | 466          | 5016            | 75.00      | \$ 425,000                     |
| 112     | 467.4        | 5031            | 84.48      | \$ 425,000                     |
| 113     | 470.9        | 5069            | 83.85      | \$ 425,000                     |
| 114     | 482.4        | 5193            | 81.85      | \$ 425,000                     |
| 115     | 470.2        | 5061            | 83.97      | \$ 425,000                     |
| 116     | 477.3        | 5138            | 82.72      | \$ 425,000                     |
| 117     | 469.9        | 5058            | 84.03      | \$ 425,000                     |
| 118     | 473.6        | 5098            | 83.37      | \$ 425,000                     |
| 119     | 472.3        | 5084            | 83.60      | \$ 425,000                     |
| 120     | 474.8        | 5111            | 83.16      | \$ 425,000                     |
| 121     | 465.2        | 5007            | 84.87      | \$ 425,000                     |
| 122     | 466.7        | 5024            | 84.60      | \$ 425,000                     |
| 123     | 472.8        | 5089            | 83.51      | \$ 425,000                     |
| 124     | 472.1        | 5082            | 83.63      | \$ 425,000                     |
| 125     | 470.3        | 5062            | 83.95      | \$ 425,000                     |
| 126     | 470.3        | 5062            | 83.95      | \$ 425,000                     |
| 127     | 472.1        | 5082            | 83.63      | \$ 425,000                     |
| 128     | 478.7        | 5153            | 82.48      | \$ 425,000                     |
| 129     | 469.7        | 5056            | 84.06      | \$ 425,000                     |
| 130     | 469.7        | 5056            | 84.06      | \$ 425,000                     |
| 131     | 470          | 5059            | 84.01      | \$ 425,000                     |
| 132     | 535.4        | 5763            | 75         | \$ 432,224                     |
| 134     | 523.5        | 5635            | 75         | \$ 422,618                     |
| 136     | 469.7        | 5056            | 75         | \$ 379,185                     |
| 137     | 503.7        | 5422            | 75         | \$ 406,633                     |

# AVAILABLE LOTS AT HENRY HEIGHTS

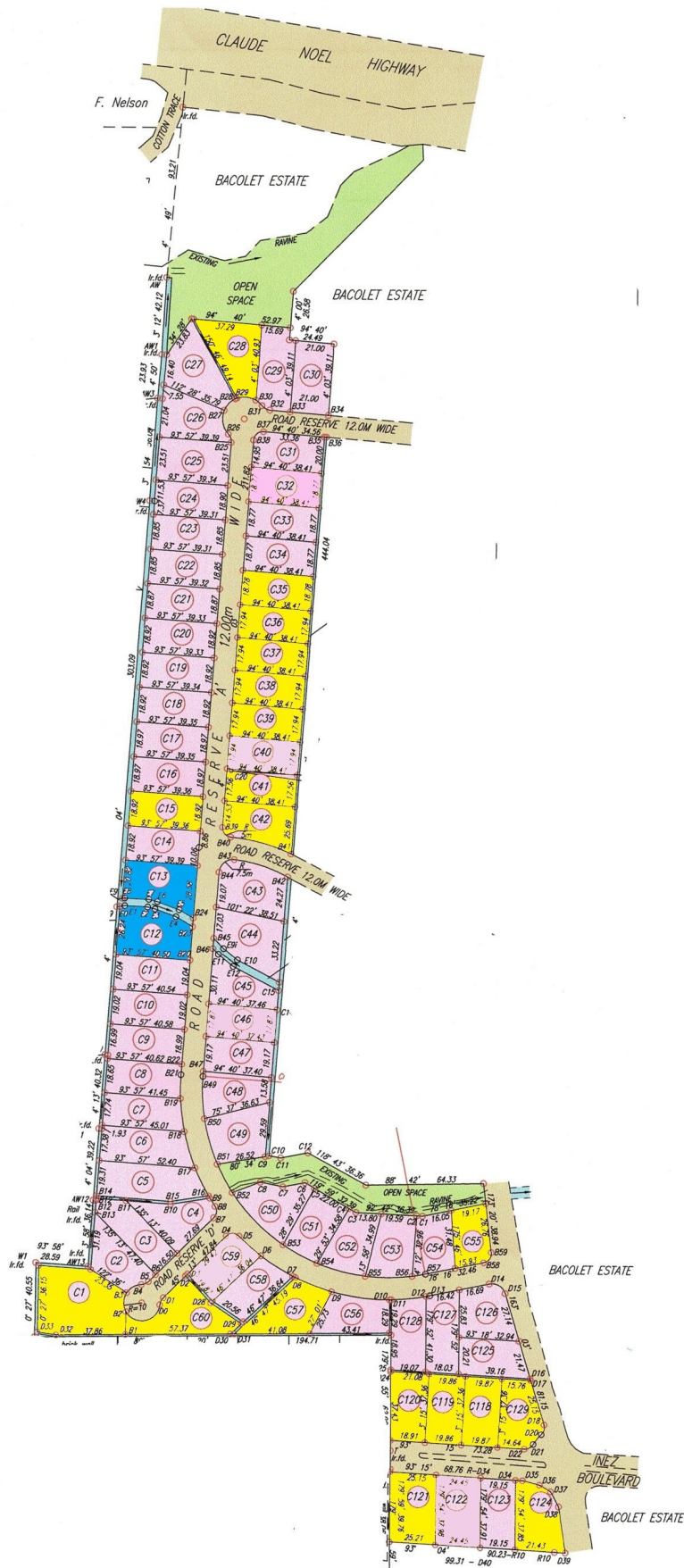

# HENRY HEIGHTS - PRICE LIST

| LOT NO. | LOT SIZE (SM) | LOT SIZE (SQFT) | PRICE /SQFT | ORIGINAL PURCHASING PRICE |
|---------|---------------|-----------------|-------------|---------------------------|
| 2       | 757.1         | 8149            | \$ 80.00    | \$651,948                 |
| 3       | 783.9         | 8438            | \$ 80.00    | \$675,026                 |
| 4       | 745           | 8019            | \$ 80.00    | \$641,528                 |
| 5       | 1063.1        | 11443           | \$ 80.00    | \$915,448                 |
| 6       | 933.8         | 10051           | \$ 80.00    | \$804,106                 |
| 7       | 746.1         | 8031            | \$ 80.00    | \$642,476                 |
| 8       | 761.6         | 8198            | \$ 80.00    | \$655,823                 |
| 9       | 771           | 8299            | \$ 80.00    | \$663,917                 |
| 10      | 771.4         | 8303            | \$ 80.00    | \$664,262                 |
| 11      | 771.3         | 8302            | \$ 80.00    | \$664,176                 |
| 12      | 1001.2        | 10777           | \$ 80.00    | \$862,145                 |
| 13      | 886.4         | 9541            | \$ 80.00    | \$763,290                 |
| 14      | 744.7         | 8016            | \$ 80.00    | \$641,270                 |
| 16      | 746.7         | 8037            | \$ 80.00    | \$642,992                 |
| 17      | 746.4         | 8034            | \$ 80.00    | \$642,734                 |
| 18      | 744.4         | 8013            | \$ 80.00    | \$641,012                 |
| 19      | 744.2         | 8010            | \$ 80.00    | \$640,840                 |
| 20      | 744.1         | 8009            | \$ 80.00    | \$640,753                 |
| 21      | 742           | 7987            | \$ 80.00    | \$638,945                 |
| 22      | 741.1         | 7977            | \$ 80.00    | \$638,170                 |
| 23      | 741           | 7976            | \$ 80.00    | \$638,084                 |
| 24      | 742.9         | 7997            | \$ 80.00    | \$639,720                 |
| 25      | 925.3         | 9960            | \$ 80.00    | \$796,787                 |
| 26      | 805           | 8665            | \$ 80.00    | \$693,195                 |
| 27      | 996.4         | 10725           | \$ 80.00    | \$858,012                 |
| 29      | 837.8         | 9018            | \$ 80.00    | \$721,440                 |

# HENRY HEIGHTS - PRICE LIST

| LOT NO. | LOT SIZE (SM) | LOT SIZE (SQFT) | PRICE /SQFT | ORIGINAL PURCHASING PRICE |
|---------|---------------|-----------------|-------------|---------------------------|
| 30      | 821.2         | 8839            | \$ 80.00    | \$707,145                 |
| 31      | 762.7         | 8210            | \$ 80.00    | \$656,770                 |
| 32      | 720.9         | 7760            | \$ 80.00    | \$620,776                 |
| 33      | 720.9         | 7760            | \$ 80.00    | \$620,776                 |
| 34      | 720.9         | 7760            | \$ 80.00    | \$620,776                 |
| 40      | 688.9         | 7415            | \$ 80.00    | \$593,220                 |
| 43      | 1001.1        | 10776           | \$ 80.00    | \$862,059                 |
| 44      | 1005.4        | 10822           | \$ 80.00    | \$865,762                 |
| 45      | 712.3         | 7667            | \$ 80.00    | \$613,370                 |
| 46      | 669           | 7201            | \$ 80.00    | \$576,084                 |
| 47      | 717.3         | 7721            | \$ 80.00    | \$617,676                 |
| 48      | 727           | 7825            | \$ 80.00    | \$626,028                 |
| 49      | 867.9         | 9342            | \$ 80.00    | \$747,359                 |
| 50      | 838.7         | 9028            | \$ 80.00    | \$722,215                 |
| 51      | 761           | 8191            | \$ 80.00    | \$655,306                 |
| 52      | 766.7         | 8253            | \$ 80.00    | \$660,215                 |
| 53      | 770.6         | 8295            | \$ 80.00    | \$663,573                 |
| 54      | 674           | 7255            | \$ 80.00    | \$580,389                 |
| 56      | 760.2         | 8183            | \$ 80.00    | \$654,617                 |
| 58      | 721.4         | 7765            | \$ 80.00    | \$621,206                 |
| 59      | 706           | 7599            | \$ 80.00    | \$607,945                 |
| 122     | 926.2         | 9970            | \$ 80.00    | \$797,562                 |
| 123     | 902.5         | 9714            | \$ 80.00    | \$777,154                 |
| 125     | 847.9         | 9127            | \$ 80.00    | \$730,137                 |
| 126     | 813.2         | 8753            | \$ 80.00    | \$700,256                 |
| 127     | 785.9         | 8459            | \$ 80.00    | \$676,748                 |
| 128     | 751.3         | 8087            | \$ 80.00    | \$646,953                 |



# AVAILABLE LOTS AT JOY GARDENS





# JOY GARDENS - PRICE LIST

| LOT NO. | LOT SIZE (SM) | LOT SIZE (SQFT) | PRICE /SQFT \$ | ORIGINAL PURCHASE PRICE |
|---------|---------------|-----------------|----------------|-------------------------|
| 28      | 617.3         | 6645            | 75             | \$498,342               |
| 78      | 507.8         | 5466            | 75             | \$409,943               |
| 79      | 546.3         | 5880            | 75             | \$441,024               |
| 89      | 572           | 6157            | 75             | \$461,771               |
| 90      | 611.7         | 6584            | 75             | \$493,821               |

# AVAILABLE LOTS AT LUTHERVILLE

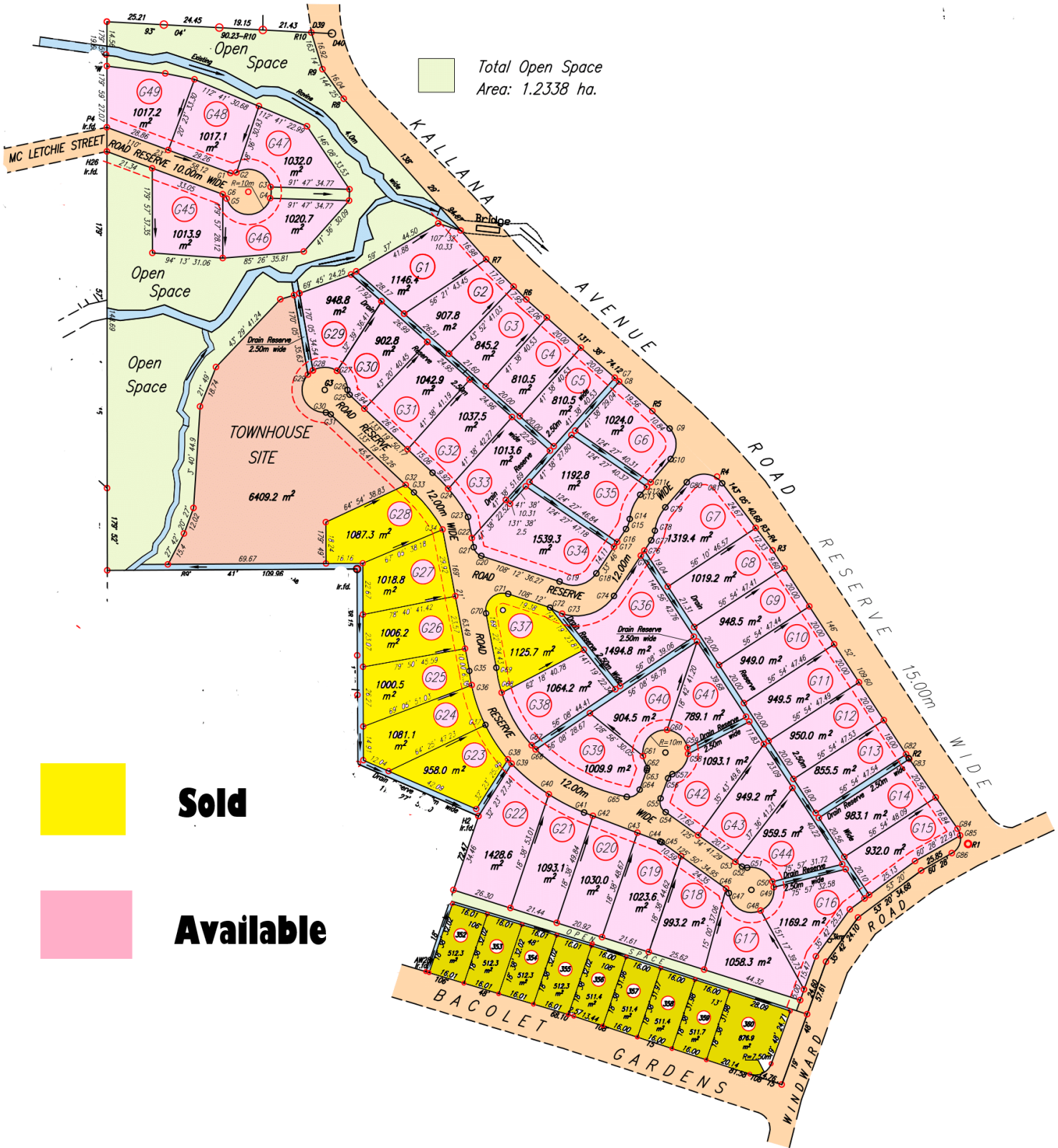

**Sold**



**Available**

# LUTHERVILLE - PRICE LIST

| LOT NO. | LOT SIZE(\$M) | LOT SIZE (SQFT) | PRICE PER SQFT | ORIGINAL PURCHASING PRICE (\$) |
|---------|---------------|-----------------|----------------|--------------------------------|
| 1       | 1146.4        | 12340           | \$ 85.00       | \$1,048,877                    |
| 2       | 907.8         | 9771            | \$ 85.00       | \$830,575                      |
| 3       | 845.2         | 9098            | \$ 85.00       | \$773,300                      |
| 4       | 810.5         | 8724            | \$ 85.00       | \$741,552                      |
| 5       | 810.5         | 8724            | \$ 85.00       | \$741,552                      |
| 6       | 1024          | 11022           | \$ 85.00       | \$936,890                      |
| 7       | 1319.4        | 14202           | \$ 85.00       | \$1,207,161                    |
| 8       | 1019.2        | 10971           | \$ 85.00       | \$932,498                      |
| 9       | 948.5         | 10210           | \$ 85.00       | \$867,813                      |
| 10      | 949           | 10215           | \$ 85.00       | \$868,270                      |
| 11      | 949.5         | 10220           | \$ 85.00       | \$868,727                      |
| 12      | 950           | 10226           | \$ 85.00       | \$869,185                      |
| 13      | 855.5         | 9209            | \$ 85.00       | \$782,724                      |
| 14      | 983.1         | 10582           | \$ 85.00       | \$899,469                      |
| 15      | 932           | 10032           | \$ 85.00       | \$852,716                      |
| 16      | 1169.2        | 12585           | \$ 85.00       | \$1,069,738                    |
| 17      | 1058.3        | 11391           | \$ 85.00       | \$968,272                      |
| 18      | 993.2         | 10691           | \$ 85.00       | \$908,710                      |
| 19      | 1023.6        | 11018           | \$ 85.00       | \$936,524                      |
| 20      | 1030          | 11087           | \$ 85.00       | \$942,379                      |
| 21      | 1093.1        | 11766           | \$ 85.00       | \$1,000,112                    |
| 22      | 1428.6        | 15377           | \$ 100.00      | \$1,537,731                    |
| 29      | 948.8         | 10213           | \$ 100.00      | \$1,021,279                    |
| 30      | 902.8         | 9718            | \$ 100.00      | \$971,765                      |



# LUTHERVILLE - PRICE LIST

| LOT NO. | LOT SIZE(SM) | LOT SIZE (SQFT) | PRICE PER SQFT | ORIGINAL PURCHASING PRICE (\$) |
|---------|--------------|-----------------|----------------|--------------------------------|
| 31      | 1042.9       | 11226           | \$ 100.00      | \$1,122,567                    |
| 32      | 1037.5       | 11168           | \$ 100.00      | \$1,116,755                    |
| 33      | 1013.6       | 10910           | \$ 100.00      | \$1,091,029                    |
| 34      | 1539.3       | 16569           | \$ 100.00      | \$1,656,887                    |
| 35      | 1192.8       | 12839           | \$ 85.00       | \$1,091,330                    |
| 36      | 1494.8       | 16090           | \$ 85.00       | \$1,367,640                    |
| 38      | 1064.2       | 11455           | \$ 100.00      | \$1,145,494                    |
| 39      | 1009.9       | 10870           | \$ 85.00       | \$923,989                      |
| 40      | 904.5        | 9736            | \$ 85.00       | \$827,556                      |
| 41      | 789.1        | 8494            | \$ 85.00       | \$721,972                      |
| 42      | 1093.1       | 11766           | \$ 85.00       | \$1,000,112                    |
| 43      | 949.2        | 10217           | \$ 85.00       | \$868,453                      |
| 44      | 959.5        | 10328           | \$ 85.00       | \$877,877                      |
| 45      | 1013.9       | 10914           | \$ 85.00       | \$927,649                      |
| 46      | 1020.7       | 10987           | \$ 85.00       | \$933,871                      |
| 47      | 1032         | 11108           | \$ 85.00       | \$944,209                      |
| 48      | 1017.1       | 10948           | \$ 85.00       | \$930,577                      |
| 49      | 1017.2       | 10949           | \$ 85.00       | \$930,668                      |

# AVAILABLE LOTS AT JULYN CLOSE

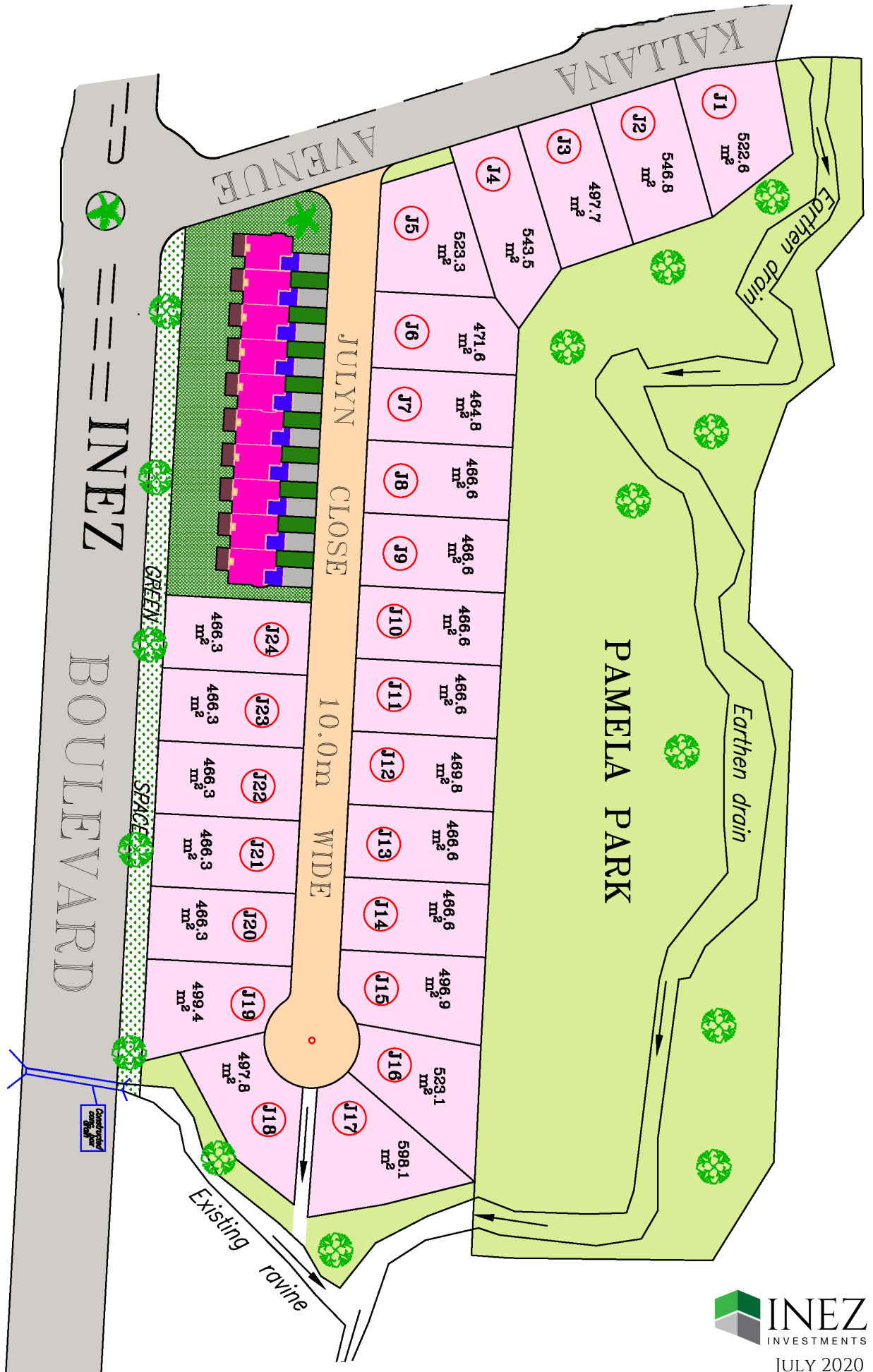

# JULYN CLOSE - PRICE LIST

| LOT NO. | LOT SIZE(SM) | LOT SIZE (SQFT) | PRICE PER SQFT | ORIGINAL PURCHASING PRICE (\$) |
|---------|--------------|-----------------|----------------|--------------------------------|
| 1       | 522.6        | 5625            | \$ 75.00       | \$421,891                      |
| 2       | 546.8        | 5886            | \$ 75.00       | \$441,428                      |
| 3       | 497.7        | 5357            | \$ 75.00       | \$401,789                      |
| 4       | 543.5        | 5850            | \$ 75.00       | \$438,763                      |
| 5       | 523.3        | 5633            | \$ 75.00       | \$422,456                      |
| 6       | 471.6        | 5076            | \$ 75.00       | \$380,719                      |
| 7       | 464.8        | 5003            | \$ 75.00       | \$375,230                      |
| 8       | 466.6        | 5022            | \$ 75.00       | \$376,683                      |
| 9       | 466.6        | 5022            | \$ 75.00       | \$376,683                      |
| 10      | 466.6        | 5022            | \$ 75.00       | \$376,683                      |
| 11      | 466.6        | 5022            | \$ 75.00       | \$376,683                      |
| 12      | 469.8        | 5057            | \$ 75.00       | \$379,266                      |
| 13      | 466.6        | 5022            | \$ 75.00       | \$376,683                      |
| 14      | 466.6        | 5022            | \$ 75.00       | \$376,683                      |
| 15      | 496.9        | 5349            | \$ 75.00       | \$401,144                      |
| 16      | 523.1        | 5631            | \$ 75.00       | \$422,295                      |
| 17      | 598.1        | 6438            | \$ 75.00       | \$482,842                      |
| 18      | 497.8        | 5358            | \$ 75.00       | \$401,870                      |
| 19      | 499.4        | 5375            | \$ 75.00       | \$403,162                      |
| 20      | 466.3        | 5019            | \$ 75.00       | \$376,440                      |
| 21      | 466.3        | 5019            | \$ 75.00       | \$376,440                      |
| 22      | 466.3        | 5019            | \$ 75.00       | \$376,440                      |
| 23      | 466.3        | 5019            | \$ 75.00       | \$376,440                      |
| 24      | 466.3        | 5019            | \$ 75.00       | \$376,440                      |